

specifications

- powder coated steel
- right-angled (90°)
- made of steel tubes
- plate thickness about 2,5 mm
- bore holes for fixation diameter 10 mm
- angle between the downwards facing legs 60°
- poedergecoat staal
- rechte hoeken (90°)
- gemaakt van stalen buizen
- wanddikte ongeveer 2,5 mm
- schroefgaten voor bevestiging 10 mm diameter
- hoek tussen de buizen voor staanders is 60°

- acier thermolaqué par poudrage
- angle droit (90°)
- fabriqué à base de tubes
- épaisseur de la paroi environ 2,5 mm
- trous de fixation diamètre 10 mm
- angle entre les montants 60°
- pulverbeschichteter Stahl
- rechtwinkelig (90°)
- gemacht aus Rohren
- Blechdicke ca. 2,5 mm
- Bohrlöcher für Befestigung 10 mm Durchmesser
- Winkel zwischen den Beinen 60°

- termolacado por espolvoreado
- ángulos rectos (90°)
- fabricado de tubos de acero
- espesor del material aproximadamente 2,5 mm
- agujeros de fijación diámetro 10 mm
- ángulo entre los dos tubos verticales 60°
- acciaio verniciato a polvere
- angolo retto (90°)
- realizzato in tubi tondi
- spessore del materiale circa 2,5 mm
- aperture per il fissaggio con bullone 10 mm
- l'angolo tra i tubi per i pali portanti è di 60°

SWING CORNER 'RIGHT'

swing corner 'right'
 hoekverbinding 'recht'
 angle acier 'droit'
 'rechtes' Rohrverbindungstück
 ángulo columpio 'recto'
 giunto 'retto'

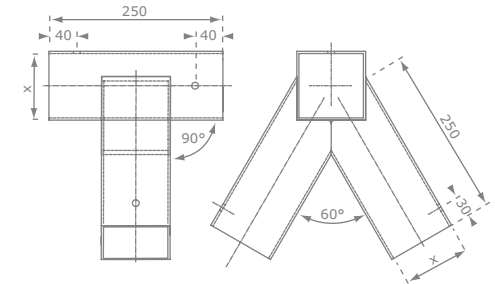
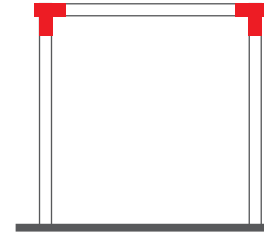

8267x	2	44 x 34 x 27 cm	13 kg
-------	---	-----------------	-------

8267x	30	410 kg	120 x 80 x 177 cm
-------	----	--------	-------------------

packaging

∅?	90 mm	90 mm
∅?	90 mm	90 mm
	6,30 kg	6,30 kg
#	82671	82672