

**BUILD &
DRIVE**

RC

Voiture de sport
Sports car

8+



Buki
France

CONTENU - CONTENTS - INHALT - INHOUD - CONTENIDO - CONTENUTO

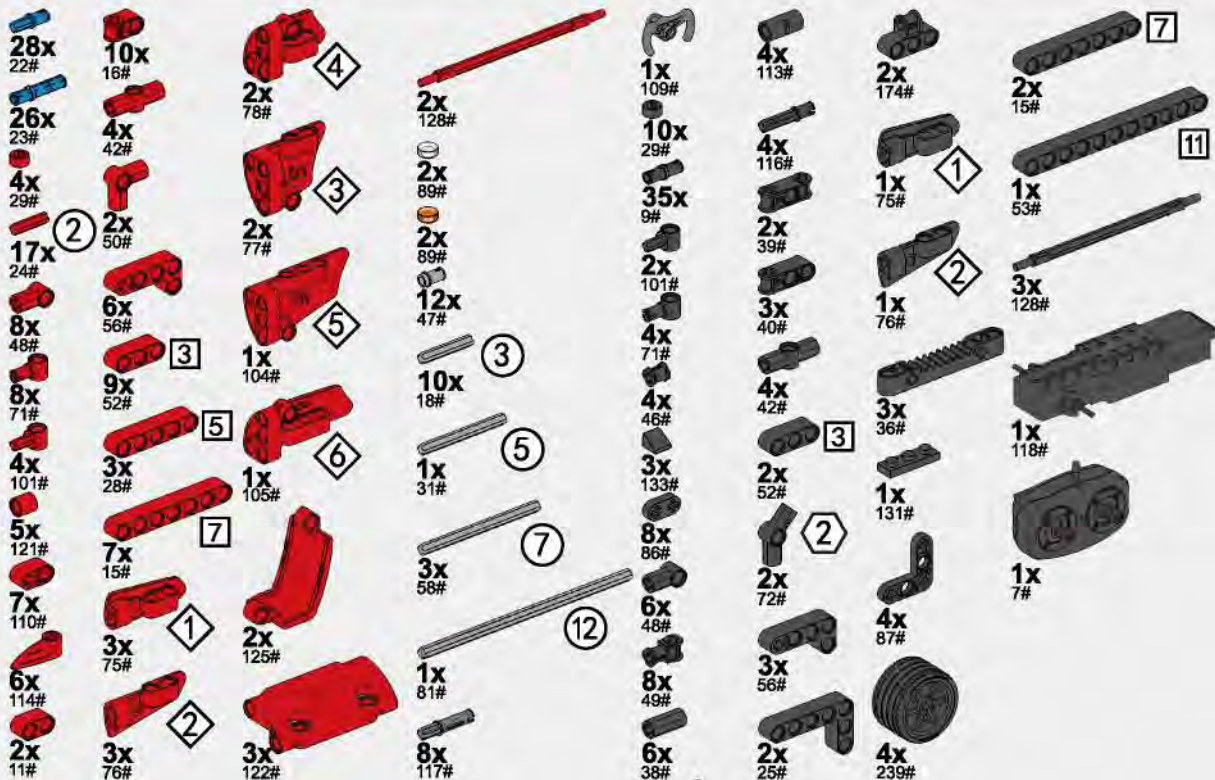

A

Supercar
Superdeportivo

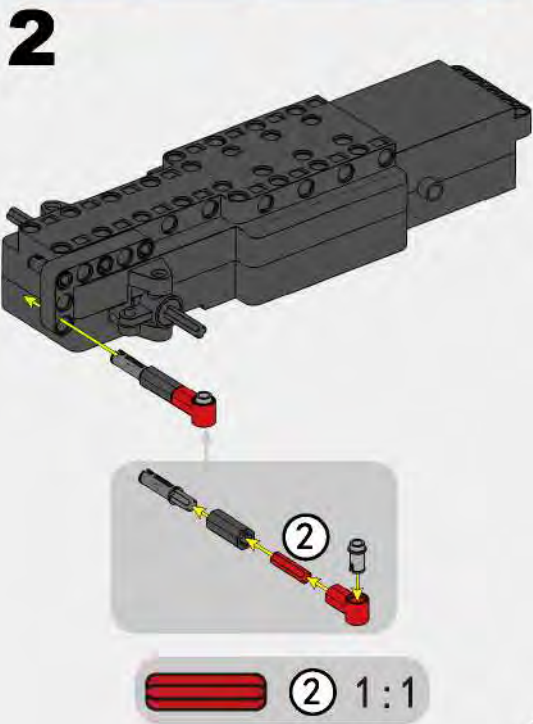
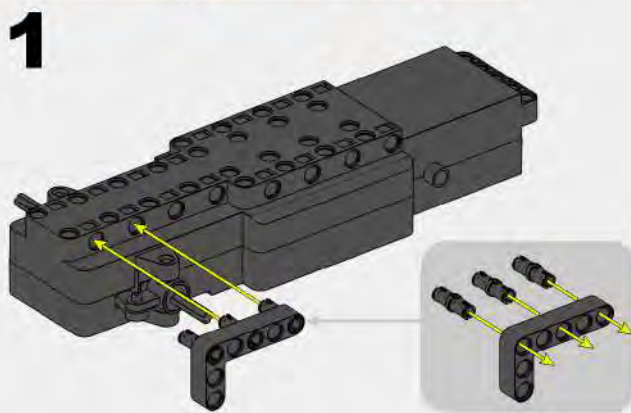

 ② 1:1



3

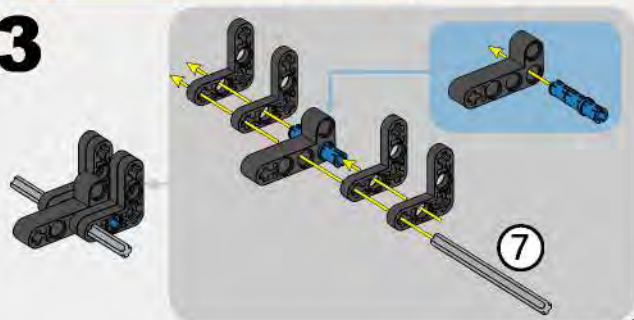

5

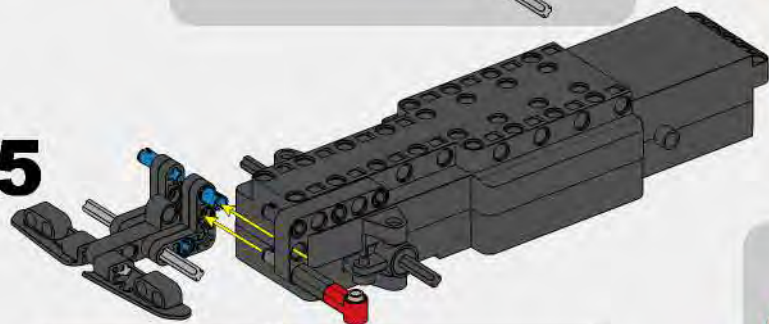

4

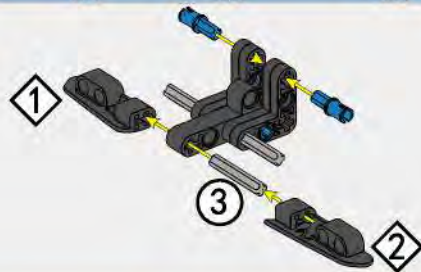

6

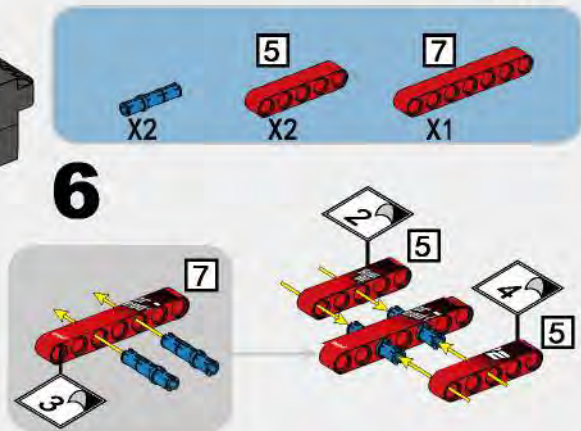



7

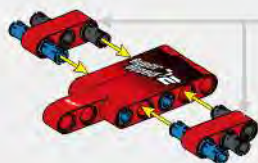

8

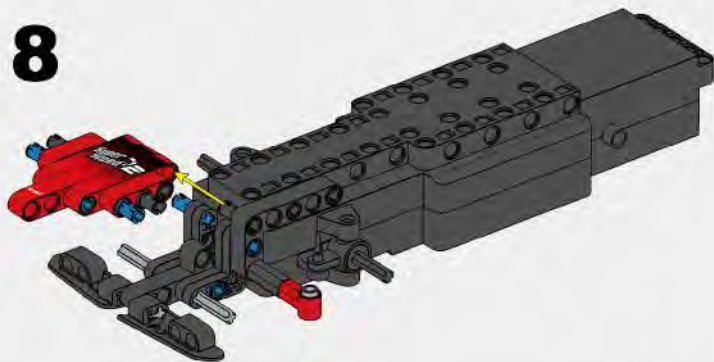

9

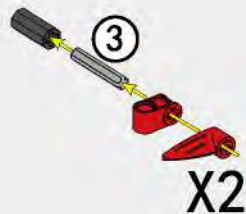

3



X1

10

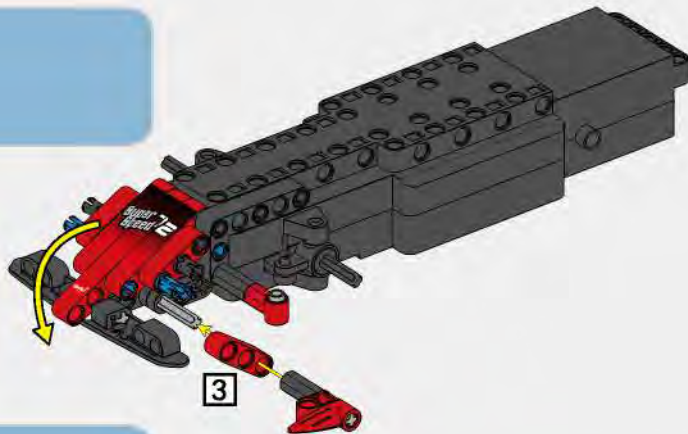

3



X1

11 

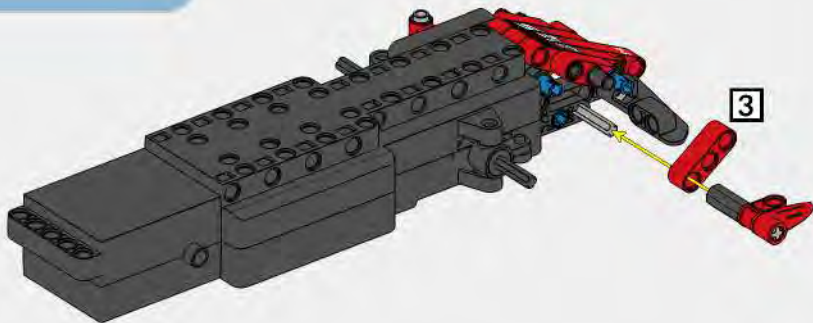



12

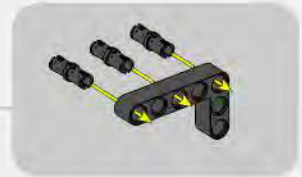
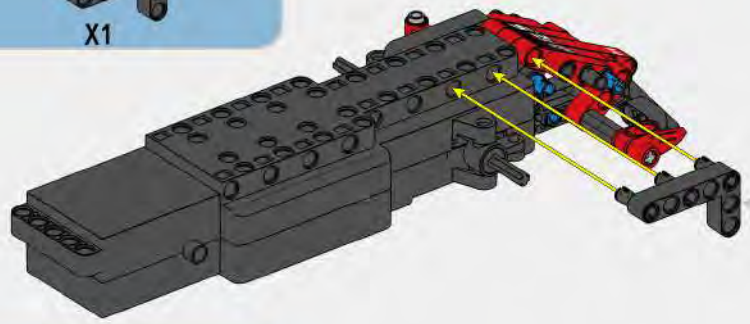

13

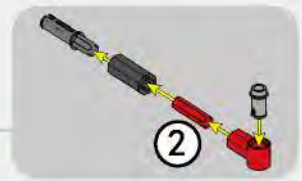
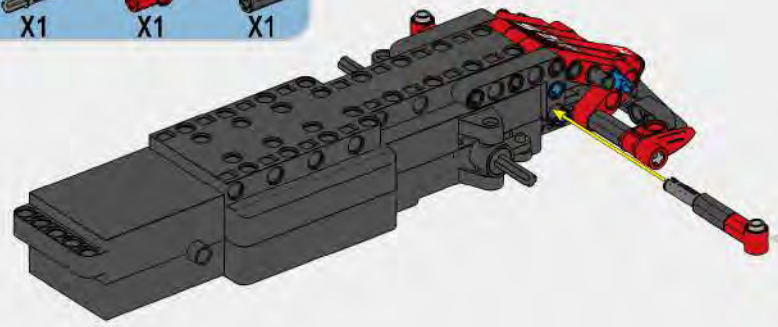



14

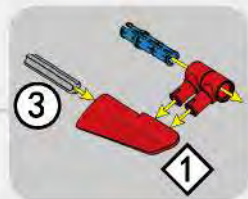
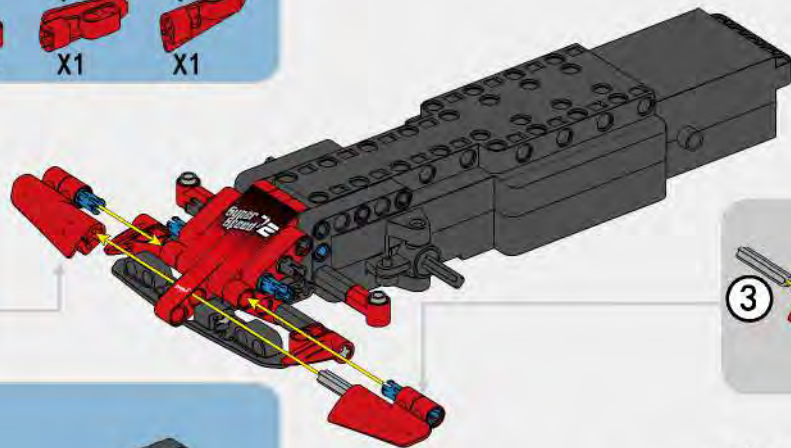

15

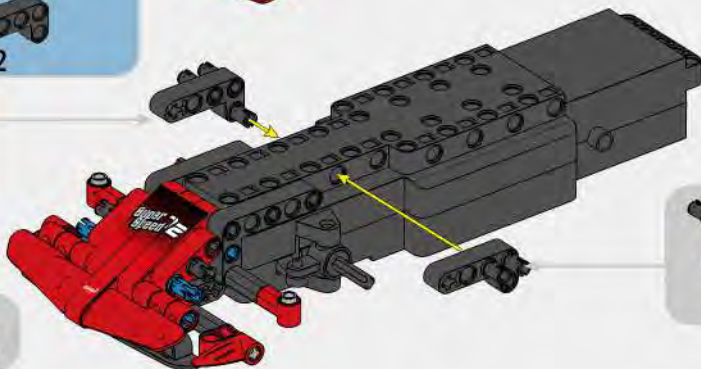
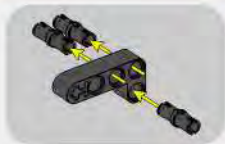



16

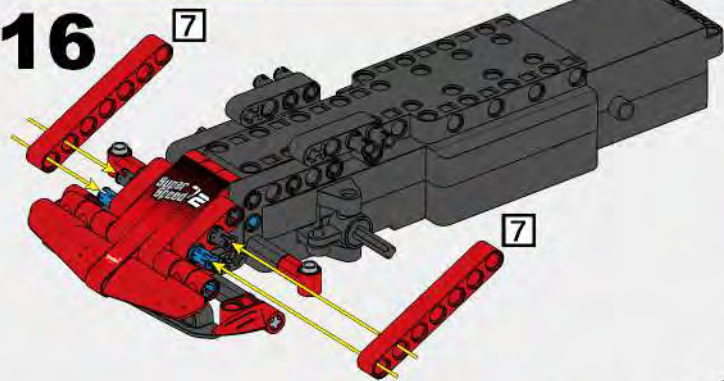

17

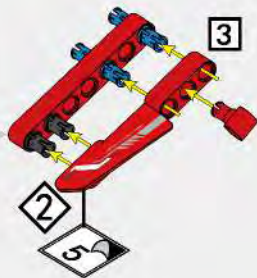
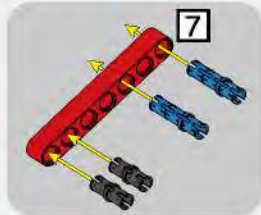

18

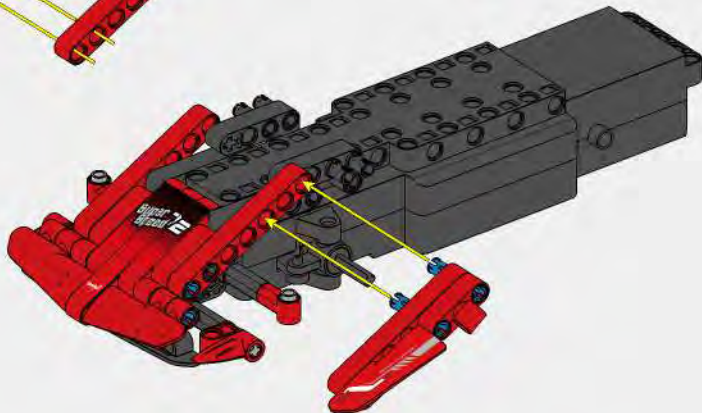

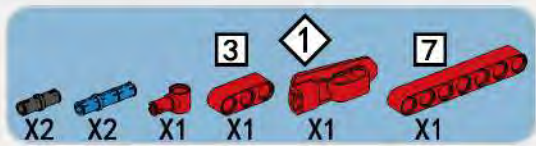

19

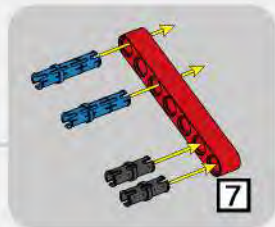
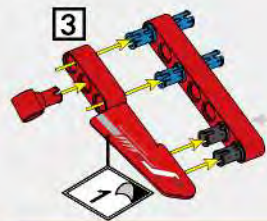

20

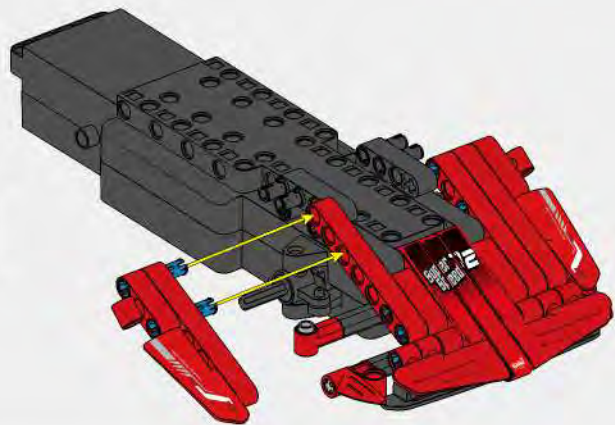

21

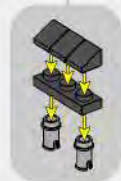
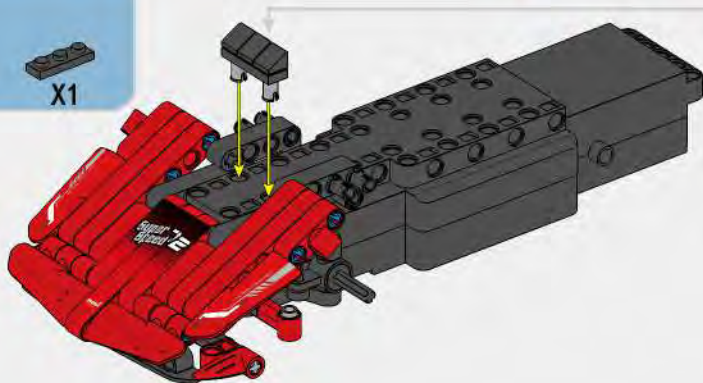



22

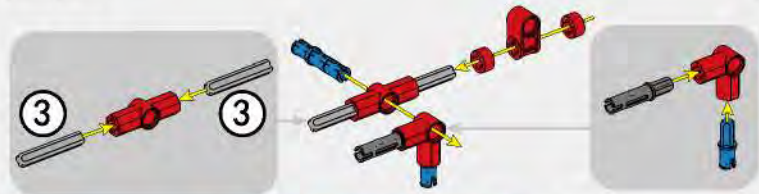

24

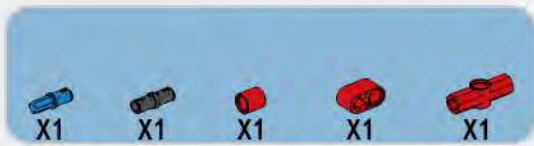

23

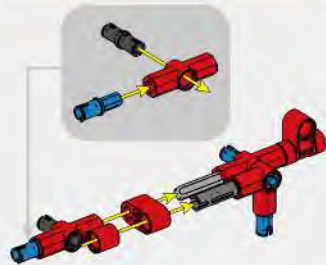

25

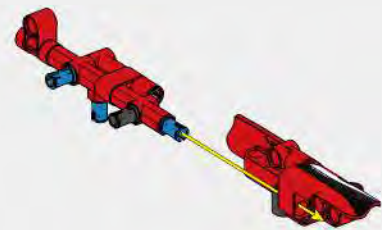

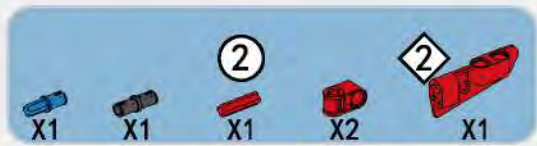

26

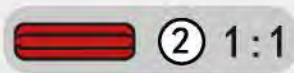
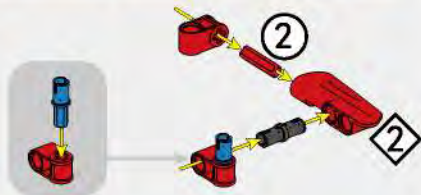

27

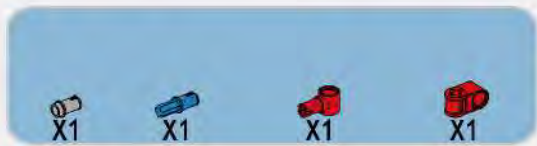
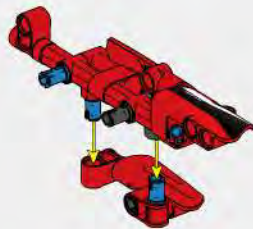

28 



29

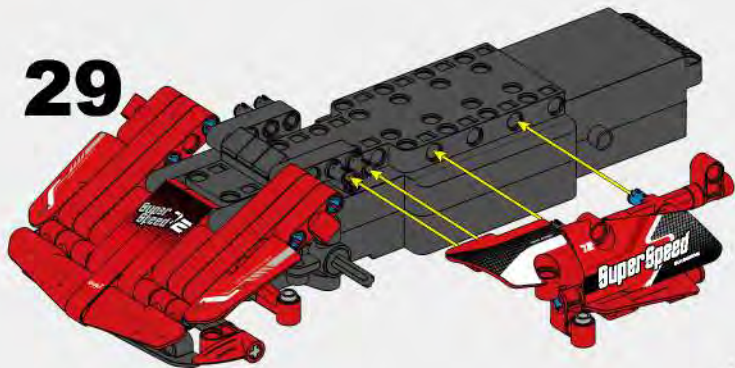



30

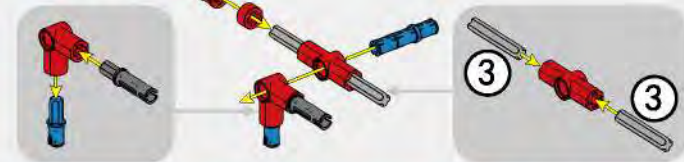

31

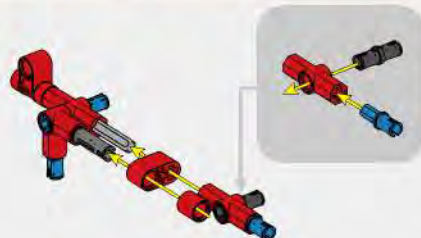

32

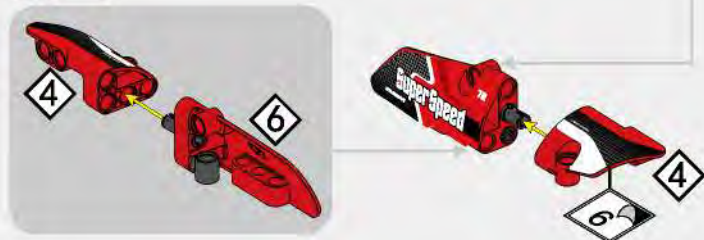

33

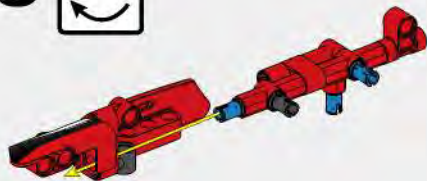

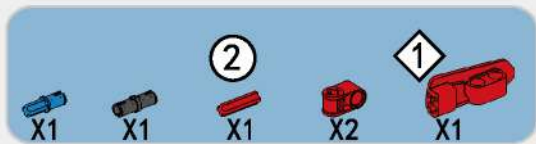

34

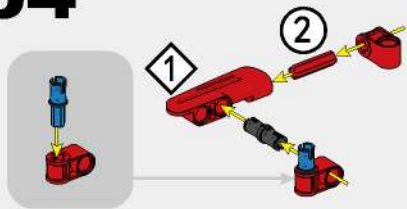

35

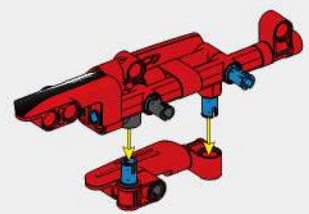

36

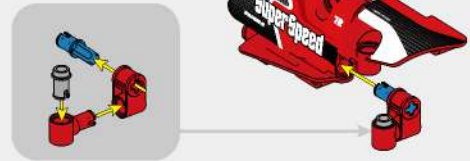

37

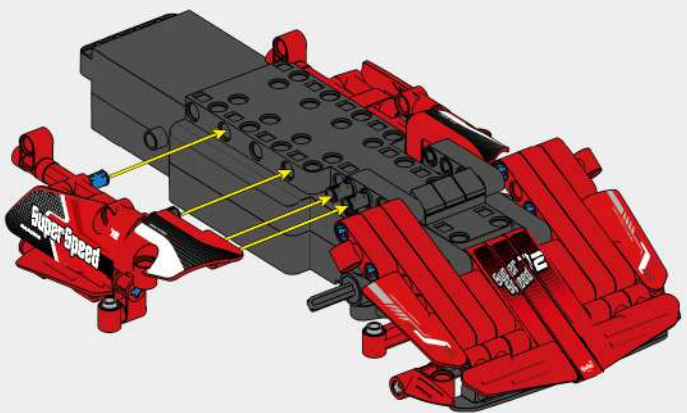

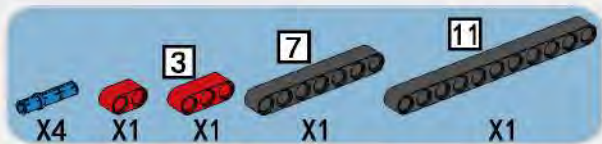

38

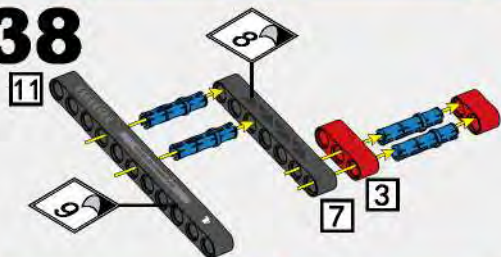

39

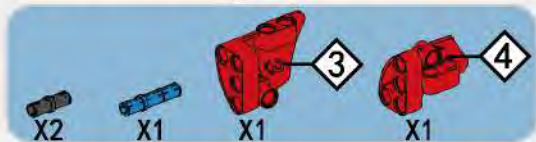
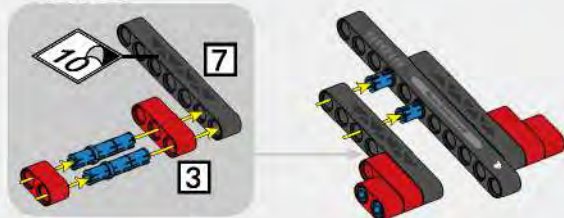

40



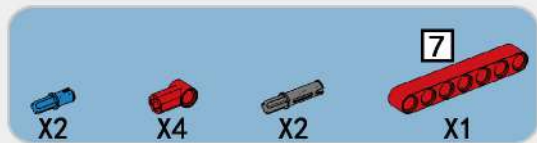

41

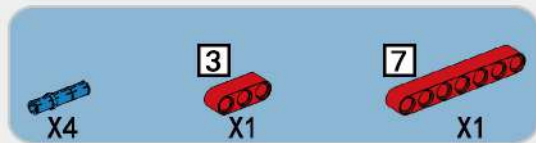
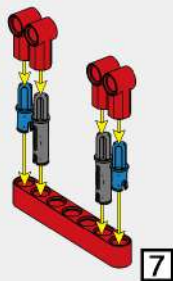

42

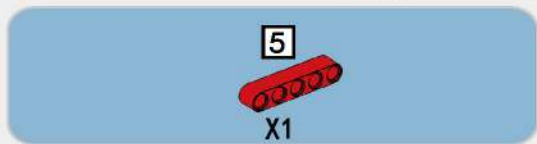
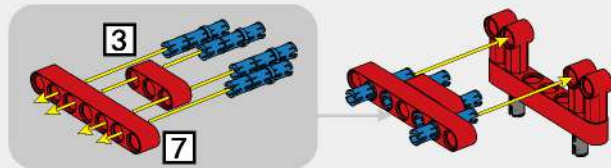

43

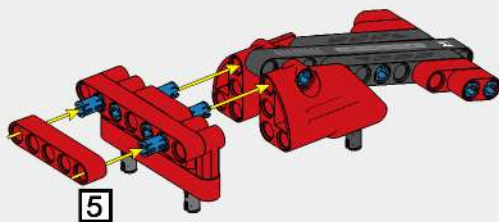

44

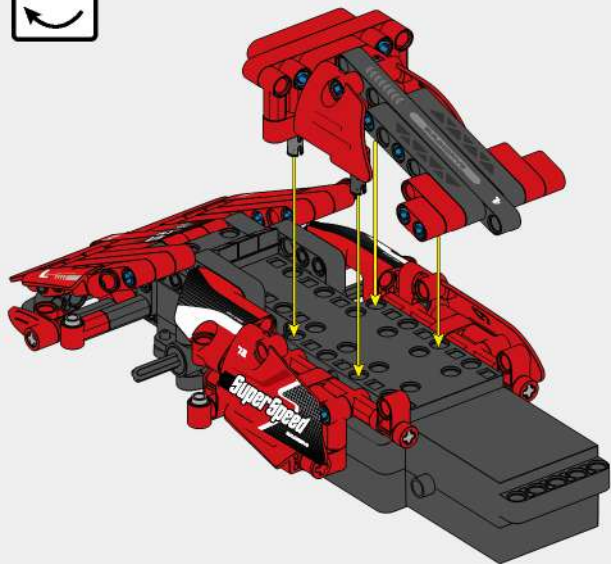

X2

X2

X2

X1

45

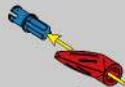

X2

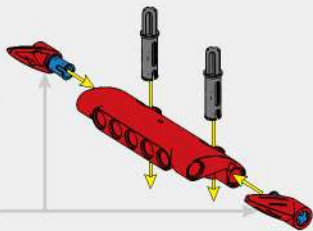

X1

X2

X1

X1

X2

46





47

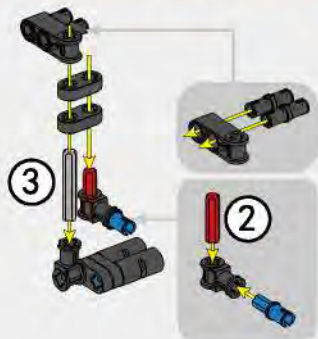

48

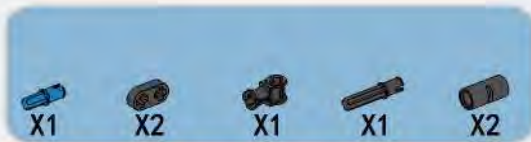

49

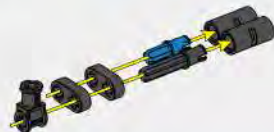

50

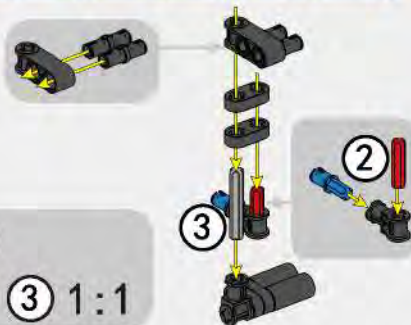



51

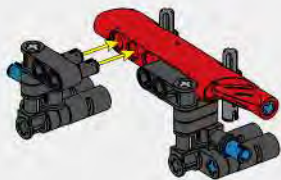

52

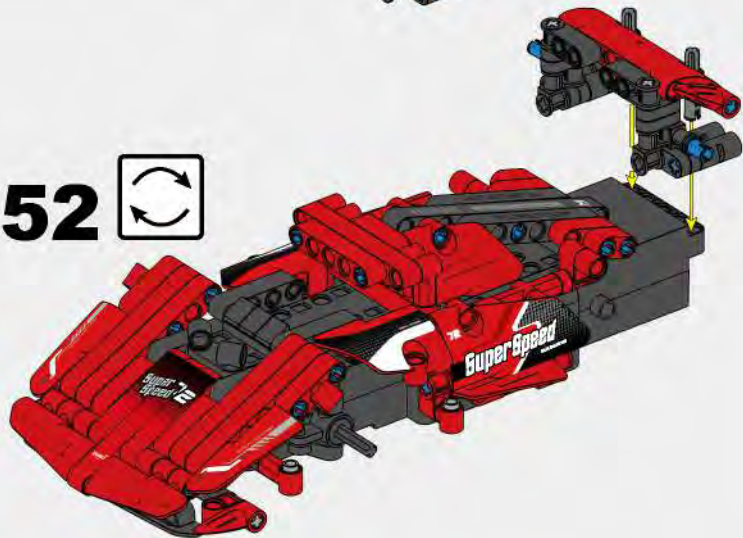

53

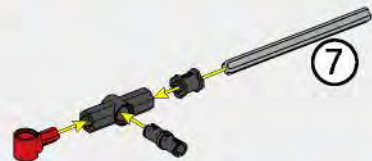

54

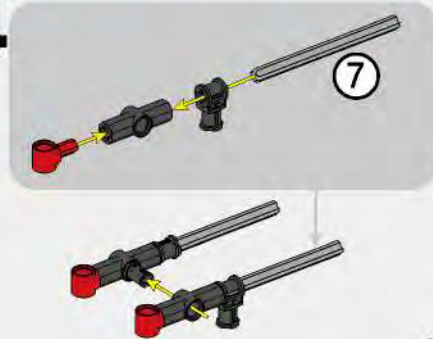



X3

55

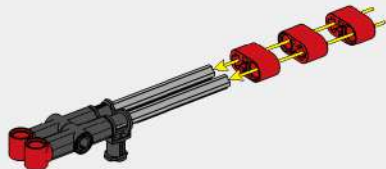

X1



X1



X1



X2



X2

56

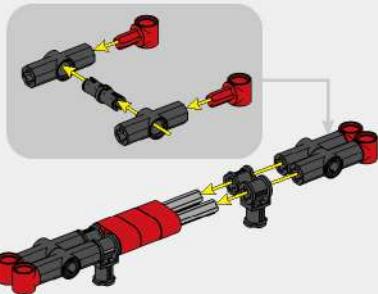

X2



X2



X2

57

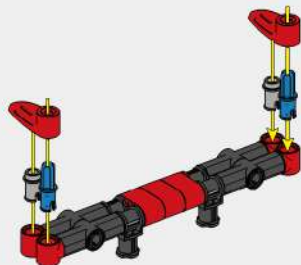

58

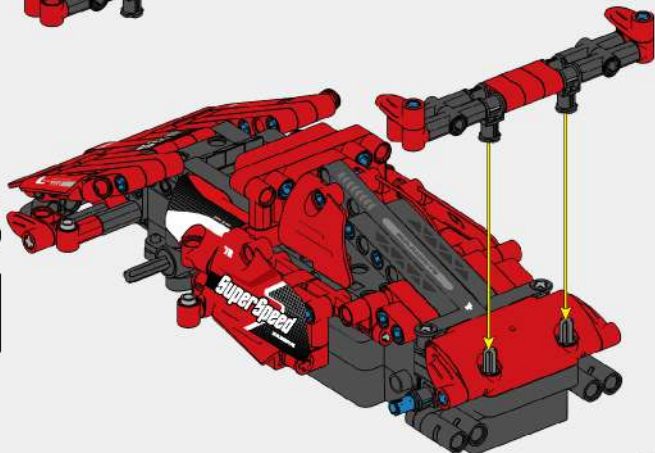

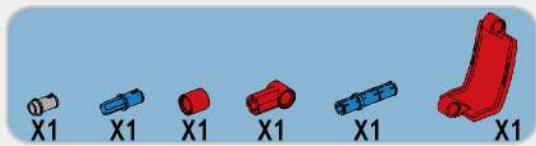

59

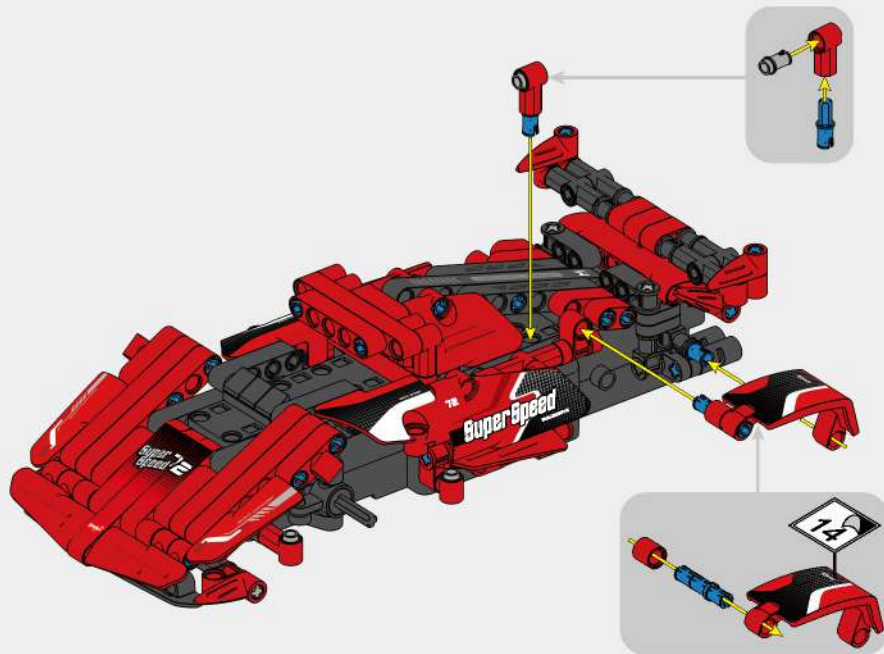

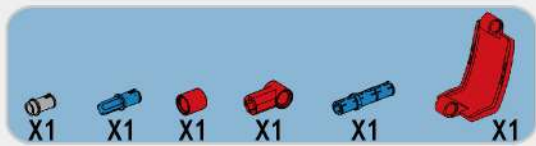

60

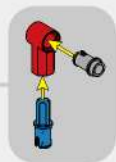
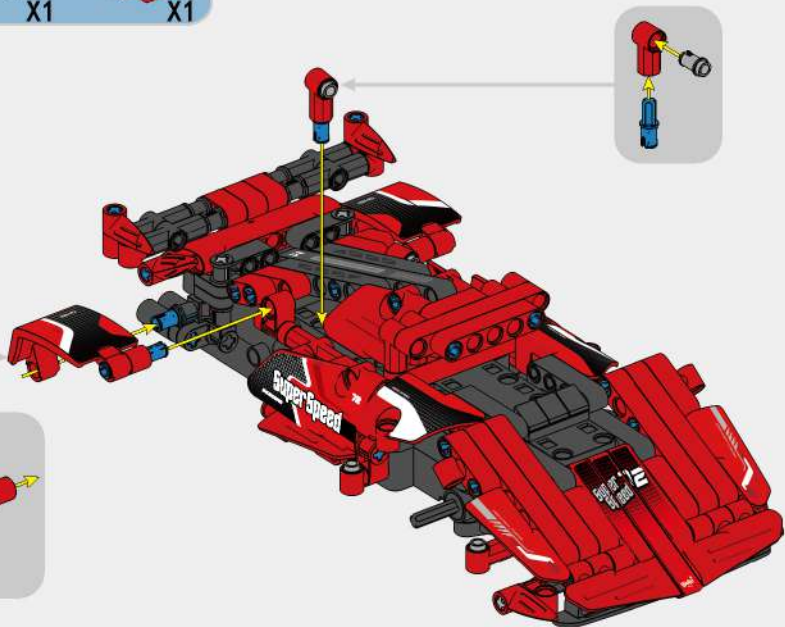
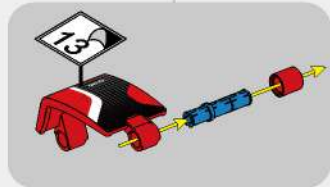



X2



X2

61



X2

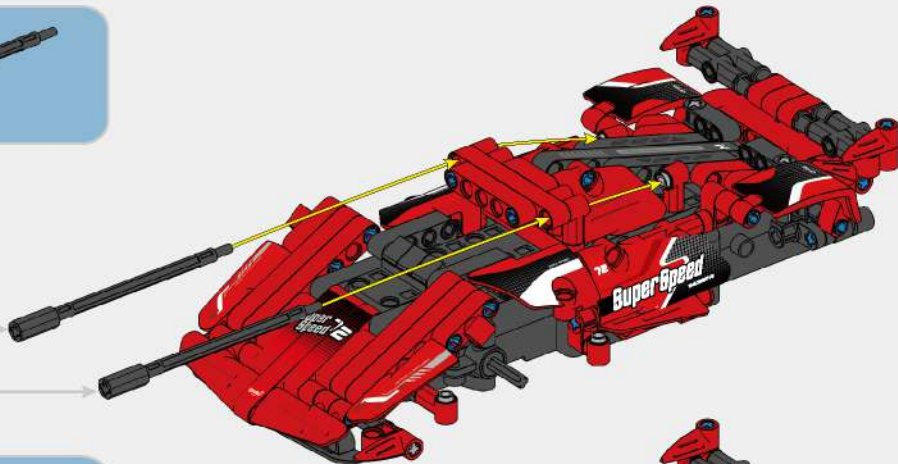

X2

62

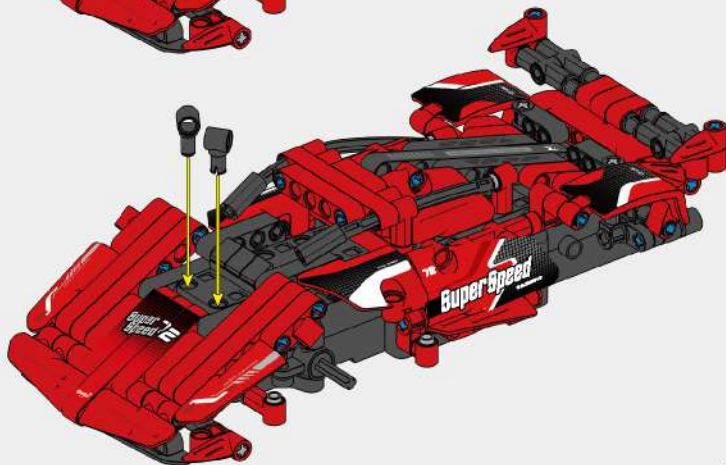



X1

63

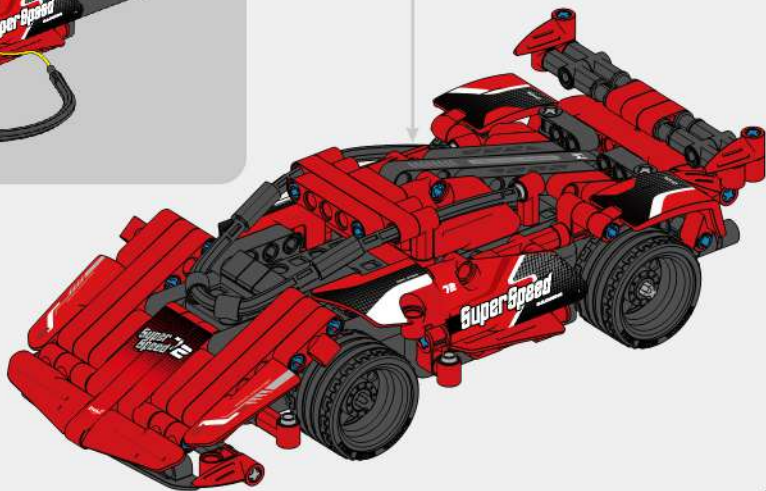
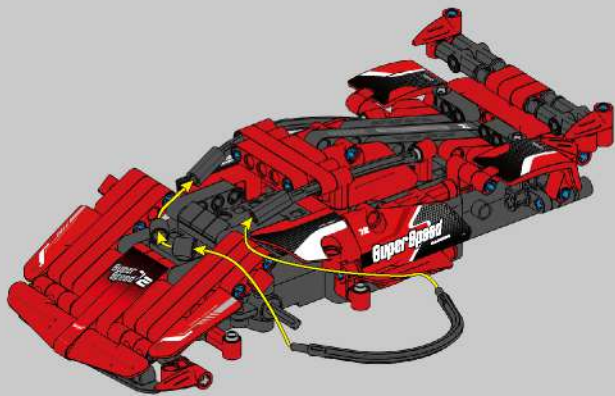



X1

64

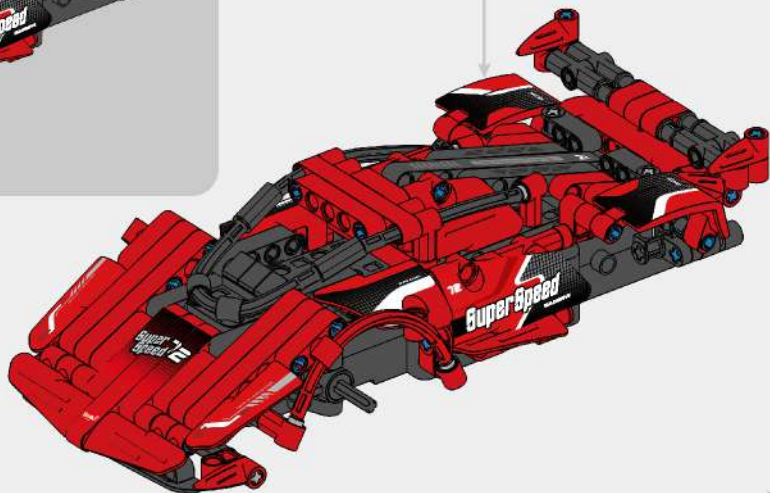
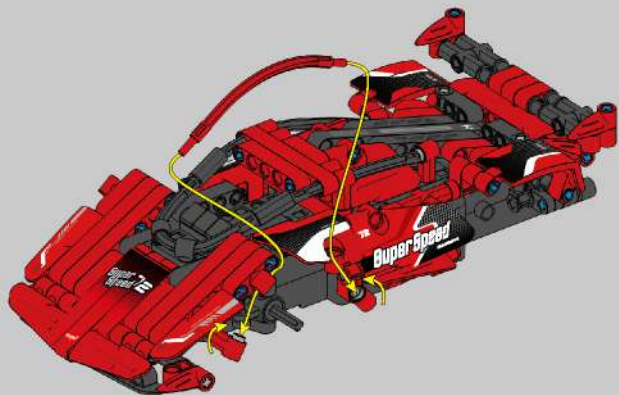



X1

65

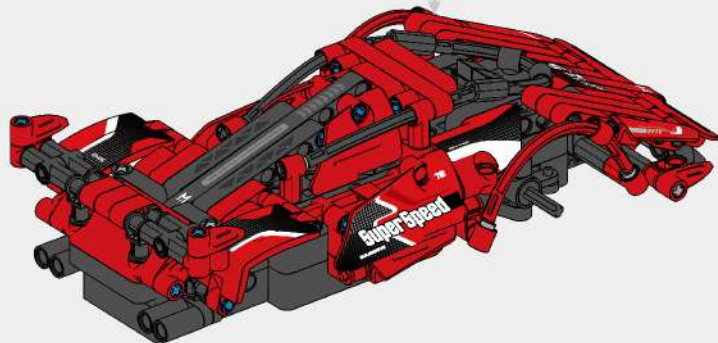
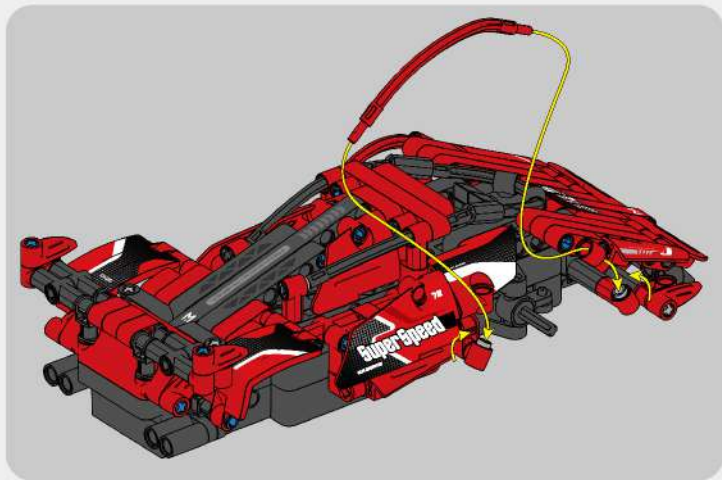



66

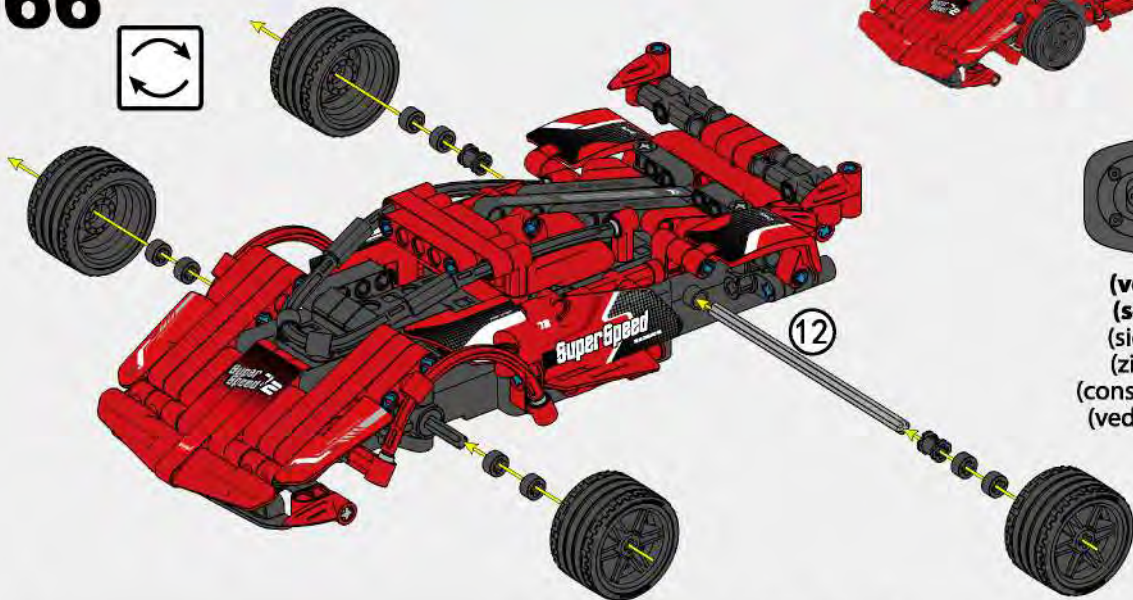

(voir page 49)
(see page 49)
 (siehe Seite 49)
 (zie pagina 49)
 (consultar la pág. 49)
 (vedere pagina 49)



12 1:1

B

Cabriolet
Descapotabile
Decappottabile

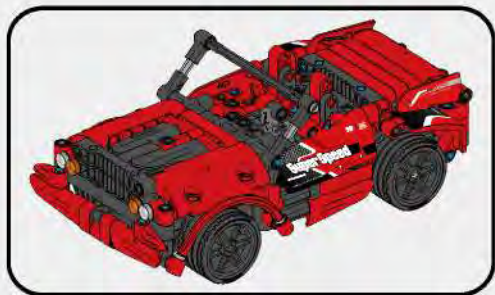

1

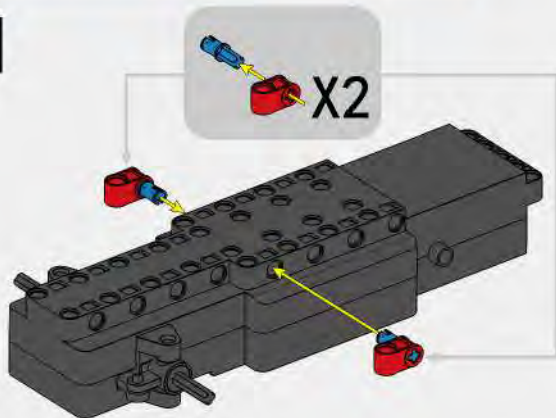

2

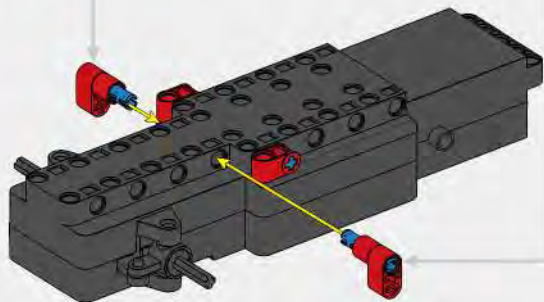

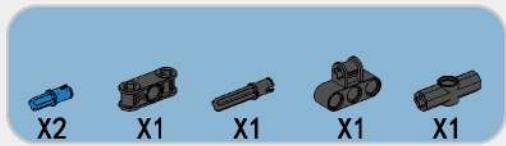

3



5

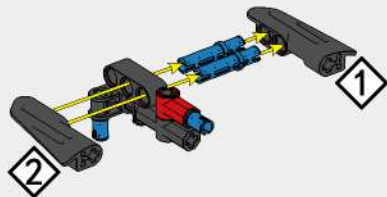

4

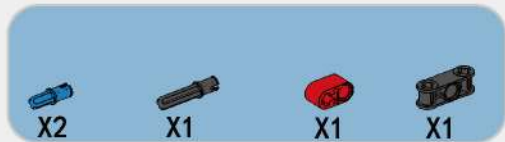
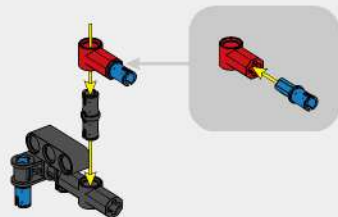

6

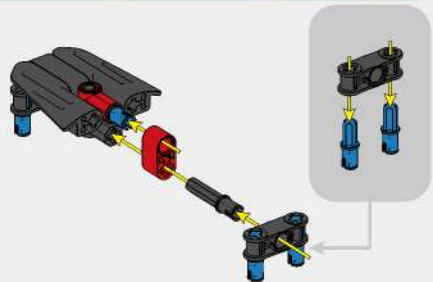

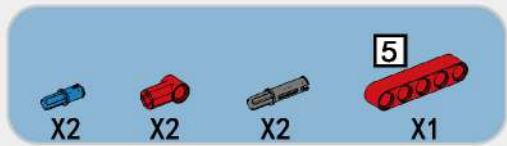

7

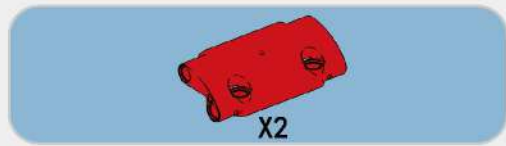
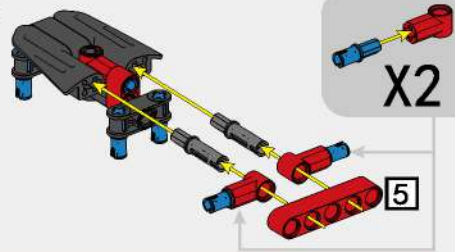

8

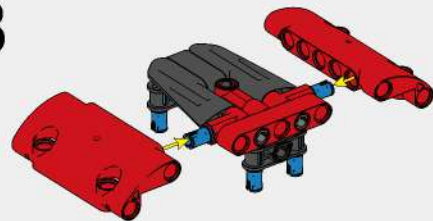

9

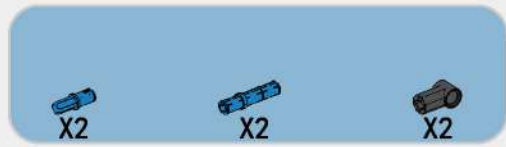
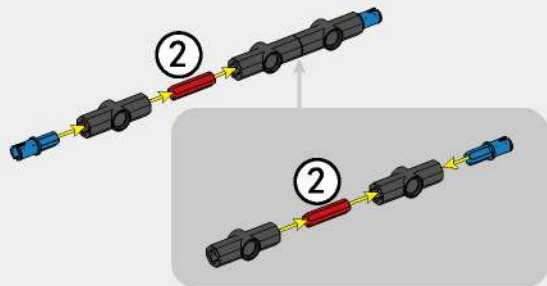

10

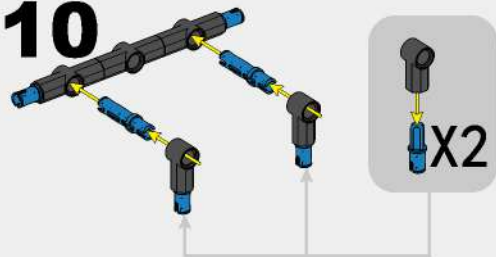

11

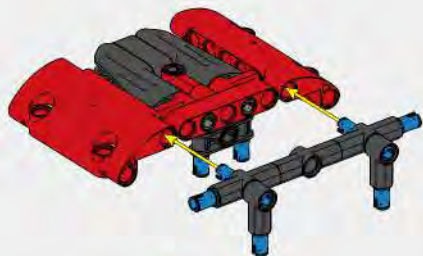

12

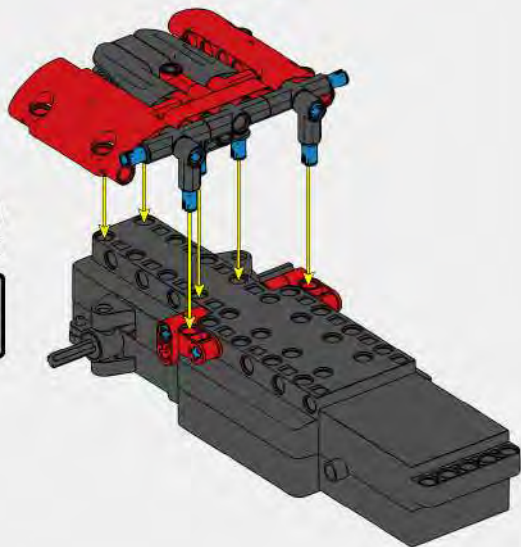

X2

2

X1

X1

X1

13

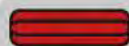
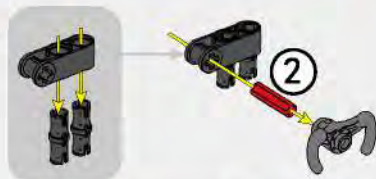

2

1:1

X2

5

X1

14

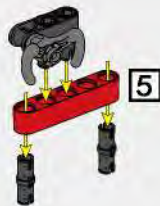



⑤ 1:1

15

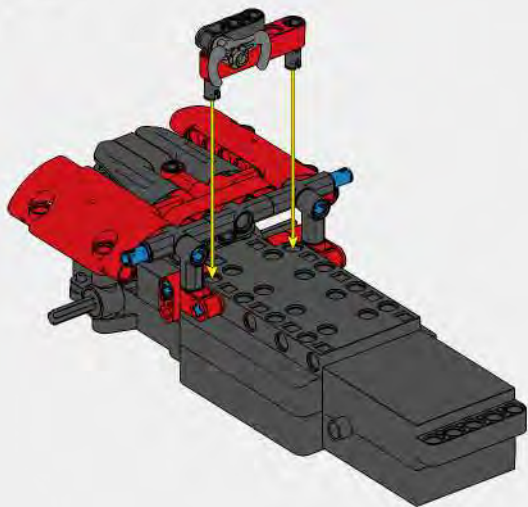

16

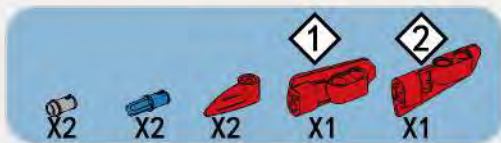
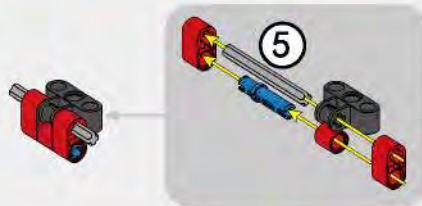

17

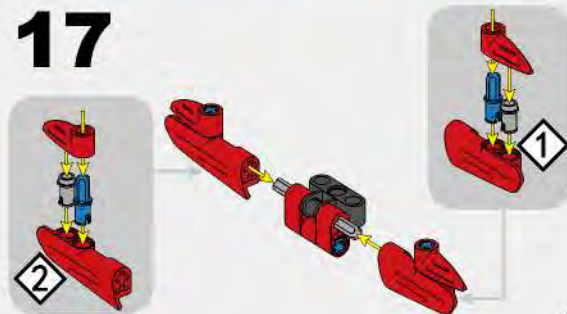



18

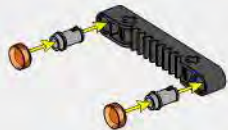

20



19

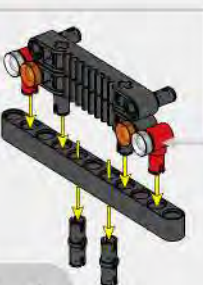
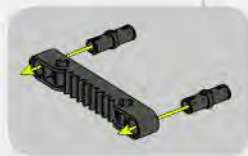

X2

X2

X4

X2

21

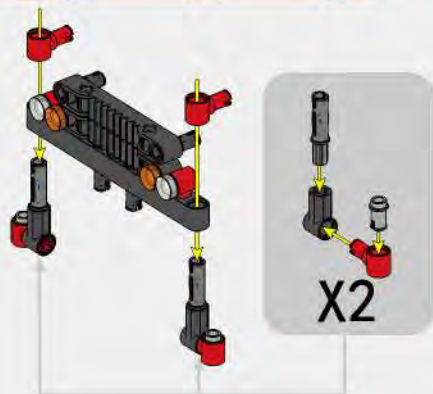

22

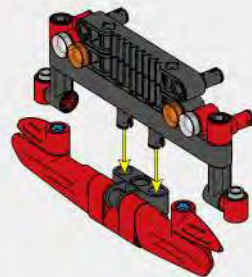

23

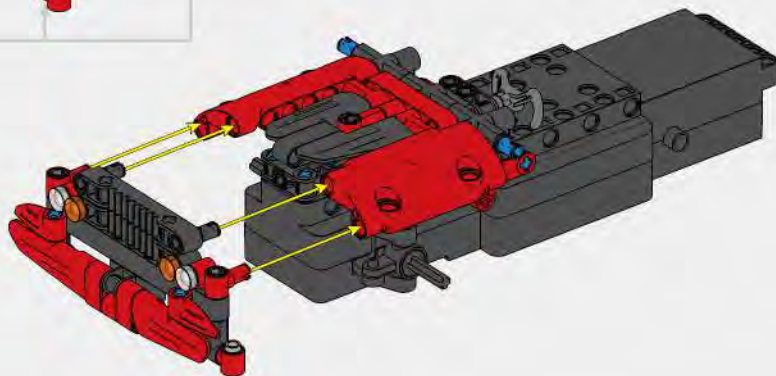



24

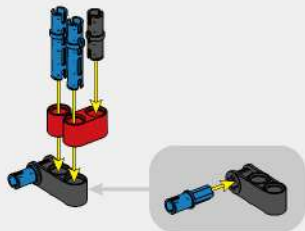

26

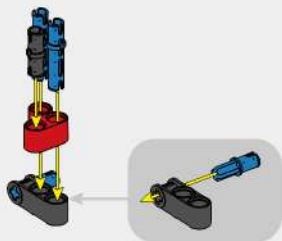

25

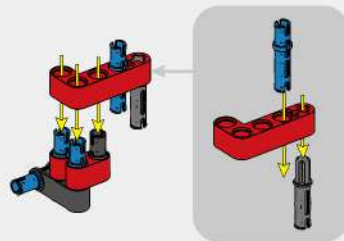

27

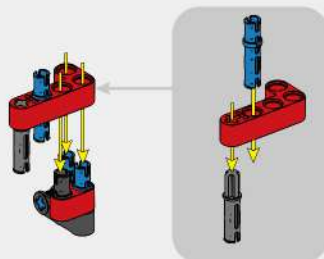

7

X1

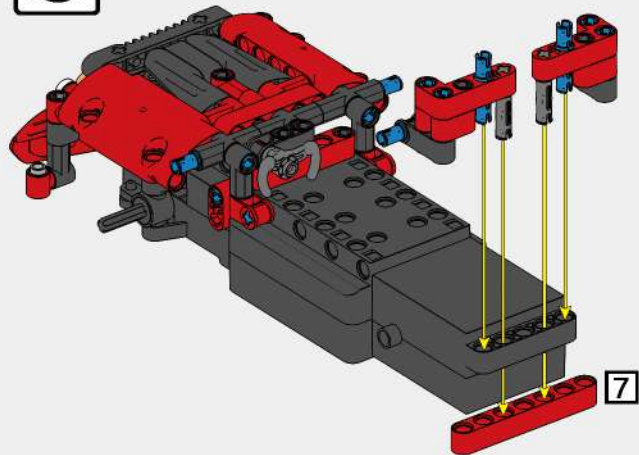
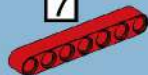
28**7**

X4

X3

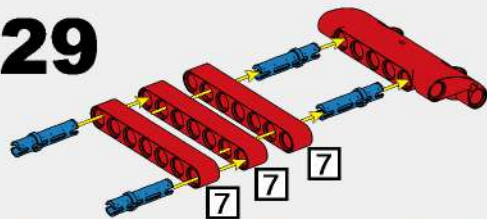

X1

29**1****2**

X2



X2



X1

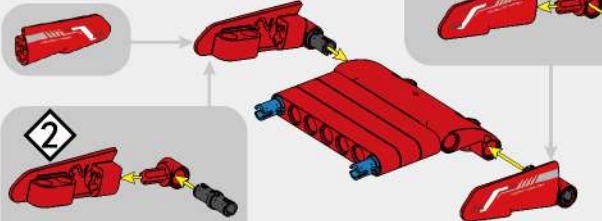

X1

30



31

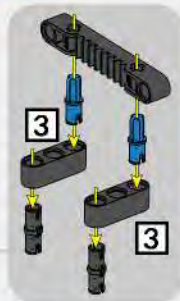
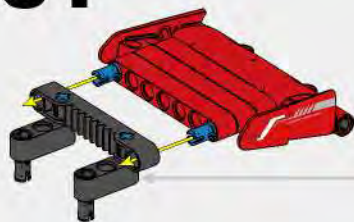

32

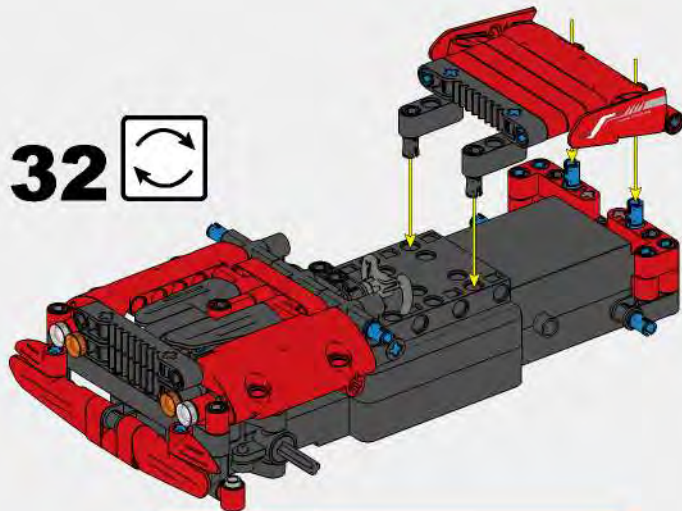

33

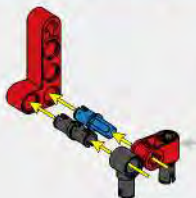

34

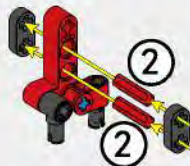

35

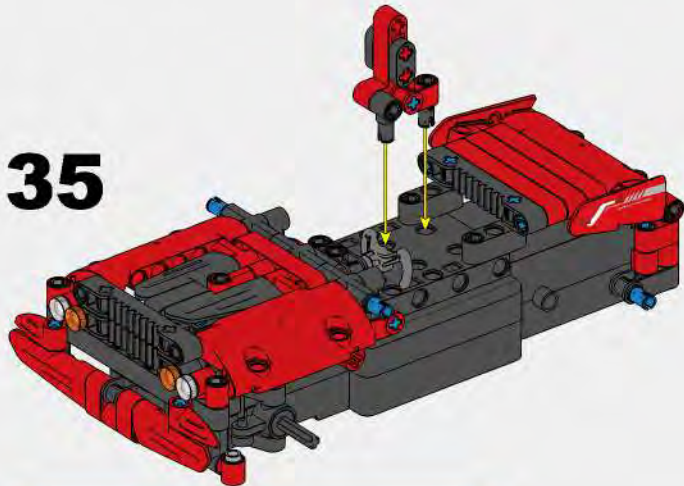

36

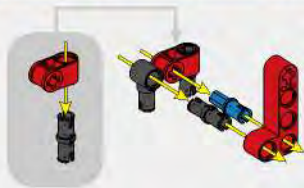

37

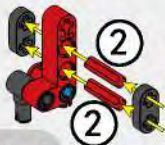

38

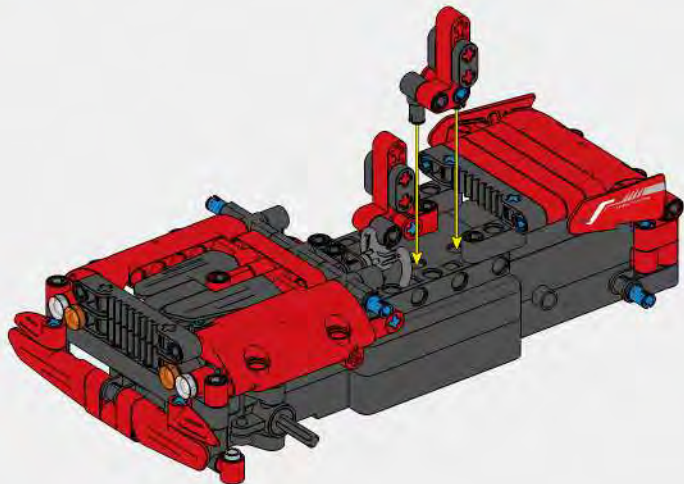



39

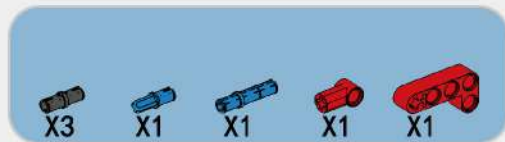
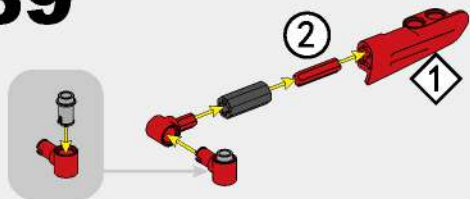

40

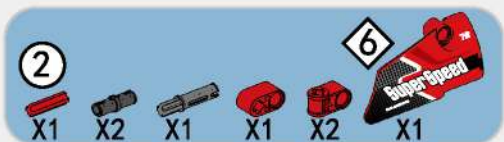
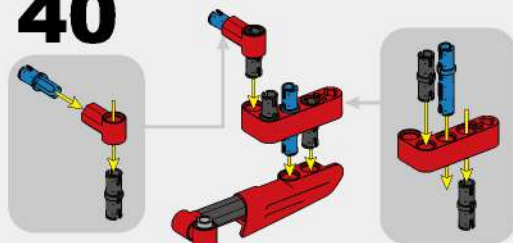

41

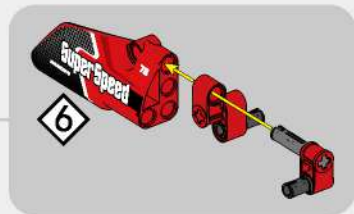
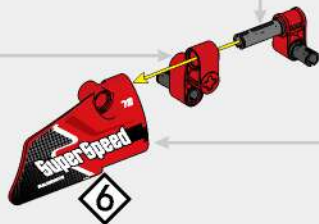
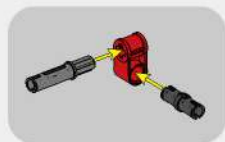
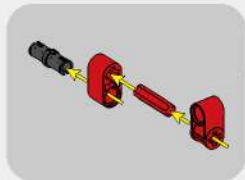



X1



X1



X1



X1

42

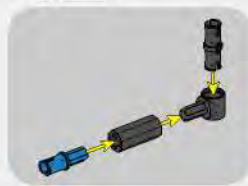

43



X1



2

X2



3

X1



X1



X1

2



X1

44



2

2



3



2



3

1:1

45



46

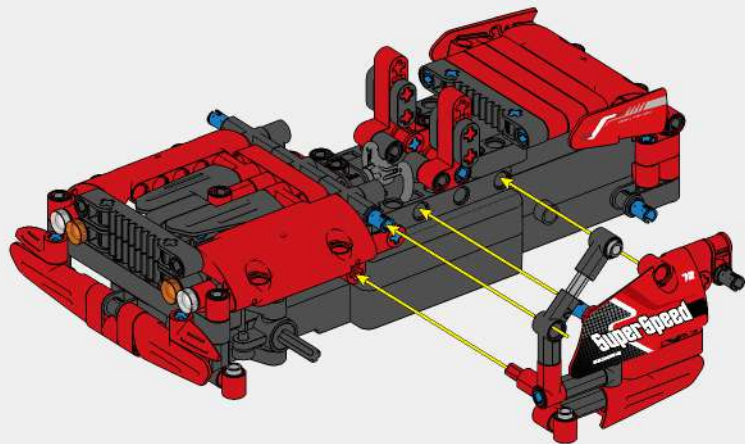

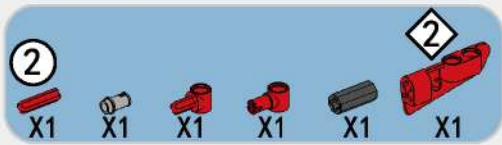

47

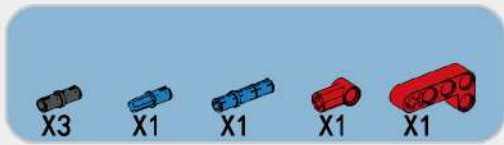
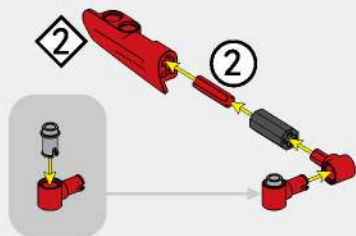

48

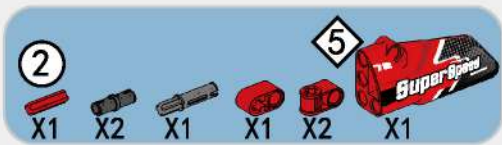
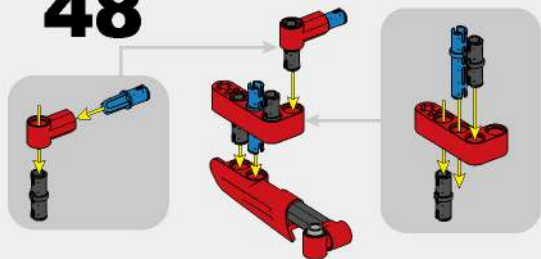

49

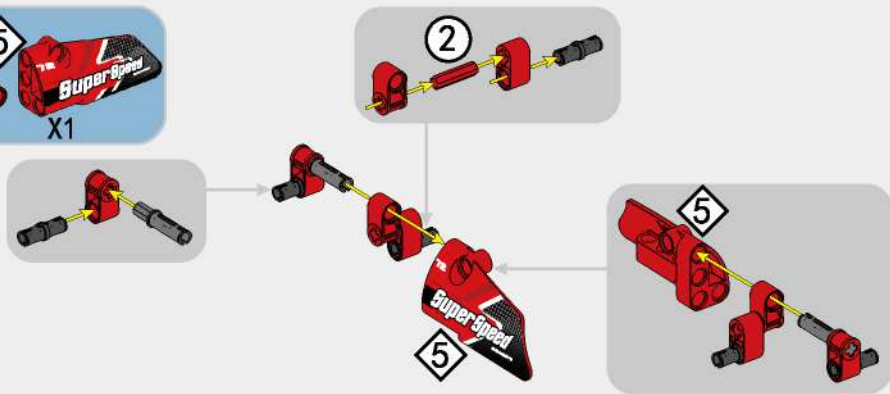

X1

X1

X1

X1

50

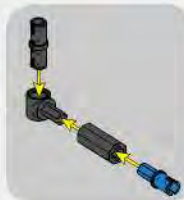

51



X1

2

X2

3

X1

X1

X1

2

X1

52



3

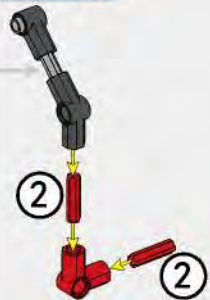

2

2

53



2

3

1:1



X1

54

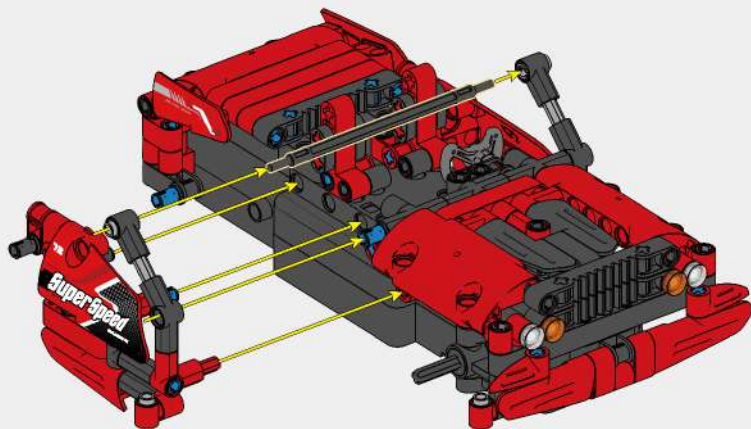



X1



X1

55

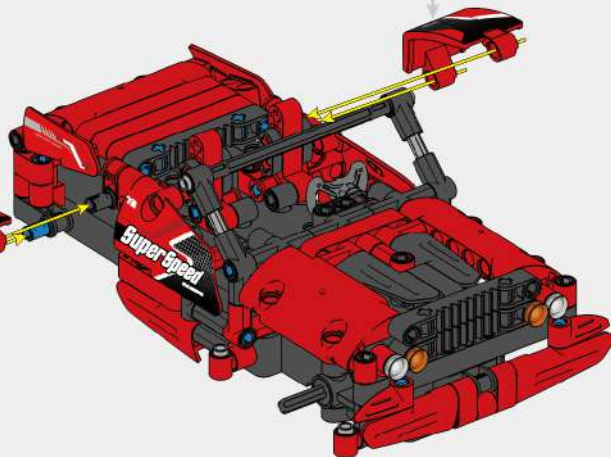
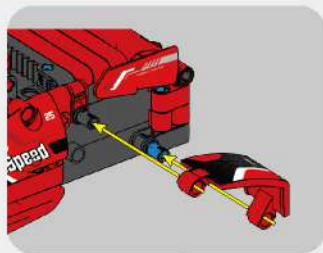



X1

56

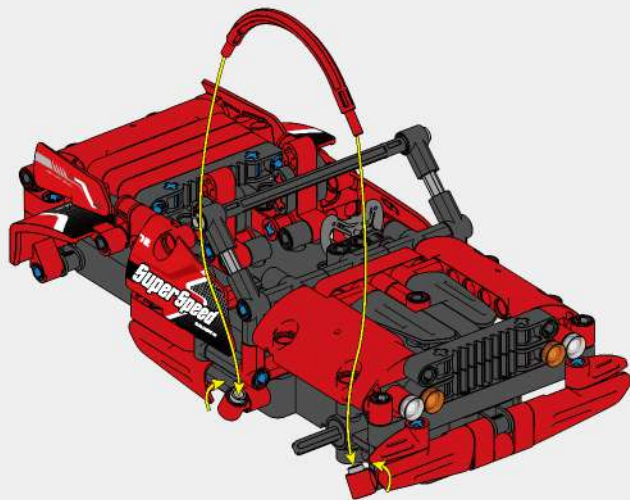



X1

57

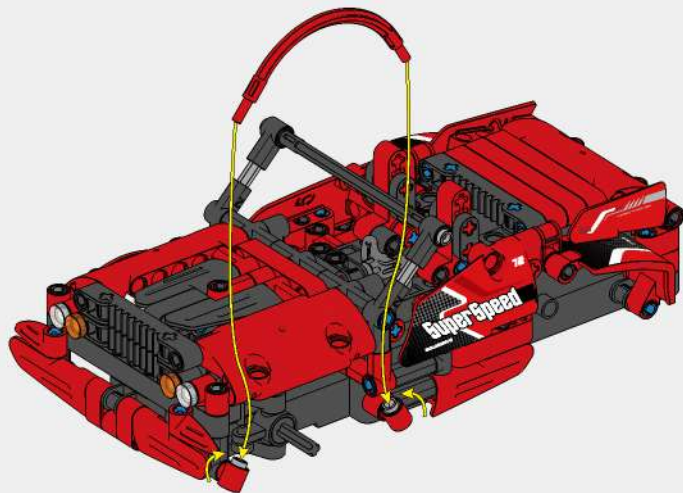



58

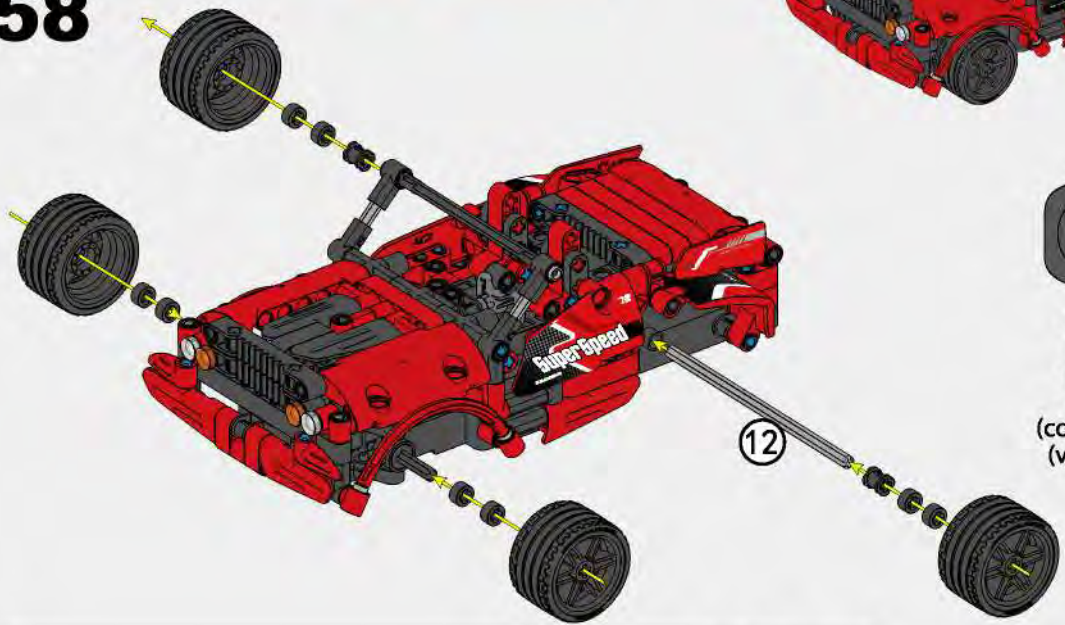

(voir page 49)
(see page 49)
 (siehe Seite 49)
 (zie pagina 49)
 (consultar la pág. 49)
 (vedere pagina 49)



Set constructie Masina Sport cu radiocomanda – BK8025

INSTRUCTIUNI

Asamblați masina sport urmând instrucțiunile color pas cu pas.

Odată asamblata, conduceți mașina cu ajutorul telecomenzii.

Telecomanda – necesita 3 baterii LR03-AAA (neincluse).

Motor – necesita 3 baterii LR06-AA (neincluse)

Bateriile trebuie schimbate de un adult. Bateriile nereincarcabile nu trebuie incarcate niciodata! Bateriile reincarcabile trebuie reincarcate si reincarcarea acestora trebuie supervizata de un adult! Bateriile reincarcabile trebuie scoase din jucarie inainte de a fi reincarcate. Nu amestecati bateriile alcaline cu cele standard sau cu cele reincarcabile! Nu folositi impreuna baterii noi cu baterii uzate! Bateriile trebuie sa fie introduse respectand polaritatea (conform imaginii)! Bateriile uzate trebuie scoase din jucarie! Bornele de alimentare nu trebuie să fie scurtcircuitate!

Pag. 49

1. Fixati intrerupatorul pe ON. Led-ul de pe telecomanda se va aprinde.
2. Corectati echilibrul rotilor.

Pag. 50

1. TEST DE FRANARE

Așezați o carte și o riglă așa cum arată imaginea. Începeți provocarea la aproximativ 2 metri distanță. Accelerați complet, apoi opriți cât mai aproape de carte.

2. SLALOM

Puneți patru cărți așa cum arată imaginea. Poziționați mașina pe linia de start și finalizați circuitul cât mai repede posibil.

Pag. 51

3. PARCAREA

Așezați trei cărți așa cum arată imaginea. Poziționați mașina la linia de start și porniți cronometrul. Parcați-vă mașina cât mai repede posibil.

4. SOFER PROFESIONIST

Creați mai multe unghiuri de viraj diferite pe podea: 45 grade, 90 grade, 180 grade. Pe măsură ce vă apropiați de colț, poziționați mașina în exterior, apoi întoarceți roțile în direcția virajului și reduceți viteza. Când ajungeți în dreptul stelutei (*), începeți să îndreptați mașina și accelerați în viraj. Creează-ți propriul circuit și îmbunătățește-ți timpii.